

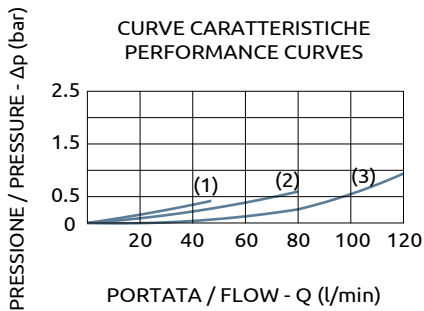

Raccordi girevoli Revolving connectors

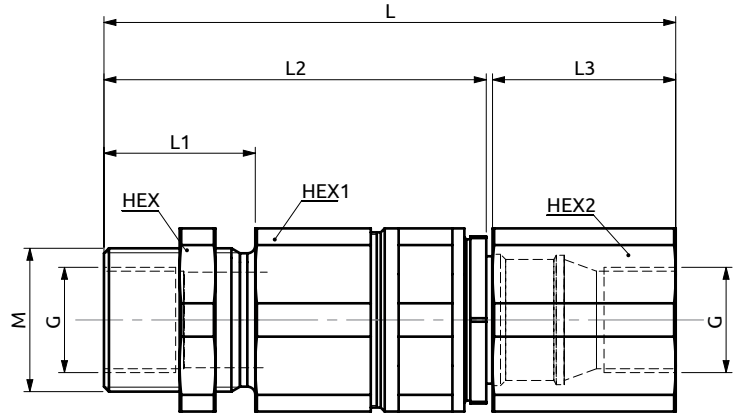
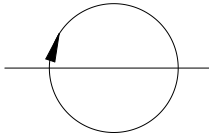

1: 3/8" G
2: 1/2" G
3: 3/4" G

Corpo in acciaio / Steel body

110.4	30	75	34	32	32	30	M24X1.5	3/8" G
111.4	32	75	35	41	36	30	M30X2	1/2" G
143.6	38	96	46	46	46	46	M36X2	3/4" G
L	L1	L2	L3	HEX	HEX1	HEX2	M	G



DESCRIZIONE

Raccordo girevole a bassa coppia di trascinamento anche a pressioni elevate.

DESCRIPTION

Revolving connector with low resistant torque even at high working pressure.

Codice Ordinazione Ordering Code	Portata Massima Max Flow	Pressione Max Max Pressure	Dimensione Porte M Port Size M	Dimensione Porte G Port Size G	Peso Weight
A170302.51.00	45 l/min	350 bar	M24X1.5	3/8" G	0.7 kg
A170402.51.00	60 l/min	350 bar	M30X2	1/2" G	0.8 kg
A170602.51.00	120 l/min	350 bar	M36X2	3/4" G	0.95 kg